

# SD Aluminium

# LOUVRE & COVER SYSTEM PRODUCT CATALOGUE



*Versatile Louvre and Cover Systems  
Designed for Performance & Style.*

*2026-2027 Edition*

# Our Story ...

*At SD Aluminium, we specialise in smart, stylish solutions for exterior design — delivering privacy, airflow, and architectural impact. From sleek aluminium louvres to refined entrance canopies and tidy heat pump covers, our systems are engineered to withstand New Zealand's demanding climate.*

*Each design comes with engineer-certified PS1 documentation, ensuring compliance and confidence in every installation. Whether you're shielding an entrance, screening a service area, or elevating a facade, our customizable systems combine engineered strength, low-maintenance durability, and peace of mind to help shape better-built environments.*

## *Find the right fit*

*Each product in this range has been designed for a wide range of outdoor applications:*

### **Louvre System**

*For sun shading, privacy screening, or architectural features - fixed or adjustable.*

### **Window Shrouds**

*Add visual depth and passive shading for energy efficiency and privacy.*

### **Heat Pump Cover System**

*Tidy up and protect service areas while improving property aesthetics.*

### **Entrance Canopy**

*Create a defined, sheltered entryway that enhances curb appeal and shields from weather.*

# Explore Our Range ...

## Aluminium Louvre System

<i>Project Gallery</i>	_____	1 - 5
<i>Slim Rectangular Louvre Blade</i>	_____	6
<i>Fusiform Louvre Blade</i>	_____	7
<i>Quadrilateral Louvre Blade</i>	_____	8
<i>Standard Rectangular Blade</i>	_____	9
<i>Clip-on Rectangular Louvre Blade</i>	_____	10
<i>Sliding Louvre Screen System</i>	_____	10
<i>Window Shroud System</i>	_____	11
<i>Louvre System Accessories</i>	_____	12
<i>Colour Options</i>	_____	13

## Aluminium Heat Pump Covers

<i>Project Gallery</i>	_____	14
<i>Heat Pump Cover Profiles</i>	_____	15
<i>Installation &amp; Colour Options</i>	_____	16

## Entrance Canopy System

<i>Project Gallery</i>	_____	17
<i>Louvre Blade Canopy</i>	_____	18
<i>Folded Sheet Canopy</i>	_____	18



*Shade. Shelter. Style.* \_\_\_\_\_

**DESIGNED FOR  
THE WAY YOU LIVE.**

# Louvre Cladding & Window Shrouds



- Modernise any building facade with clean, architectural lines.
- Provides passive sun shading and improved thermal performance.
- Customised to suit window sizes, elevations, and project style.



# Louvre Cladding & Window Shrouds



- Enhances privacy while maintaining ventilation and daylight.
- Durable aluminium build for low maintenance and long-lasting use.
- Flexible installation to suit various building types and designs.



# Sliding Louvre Systems



- Designed for flexibility—slide open for airflow, close for privacy.
- Ideal for balconies, decks, and apartment complexes.
- Smooth operation with durable aluminium tracks and framing.

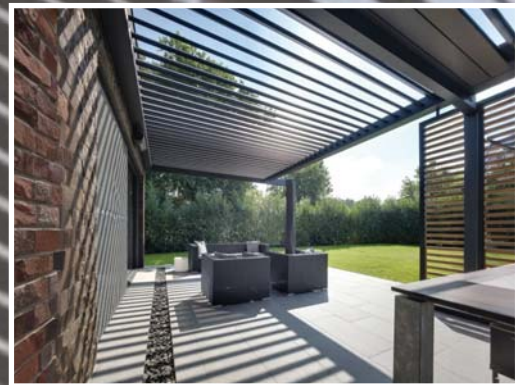

# Louvre Roofs & Blinds

- Transform outdoor spaces into sheltered, all-weather areas.
- Available in fixed or adjustable blade options.
- Integrated systems for seamless water drainage and lighting.

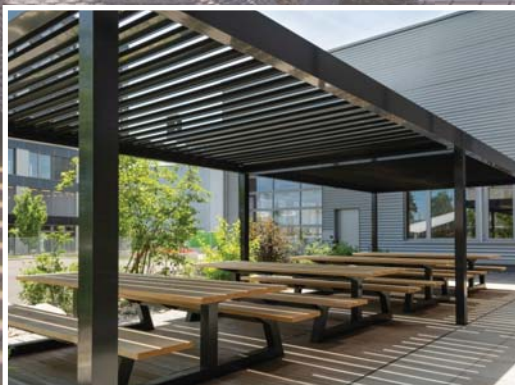
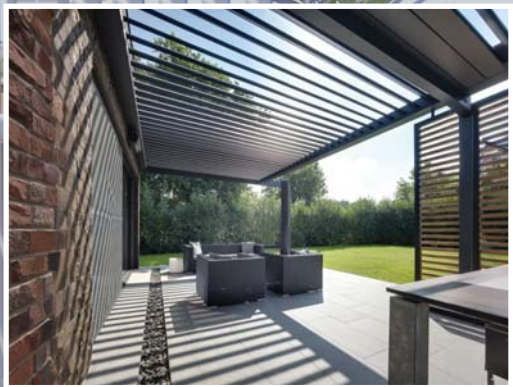

# Internal Separations

- Aluminium louvres used as stylish interior partitions or dividers.
- Balances openness and privacy in office or residential settings.
- Powder-coated finishes and blade sizes to match your design palette.

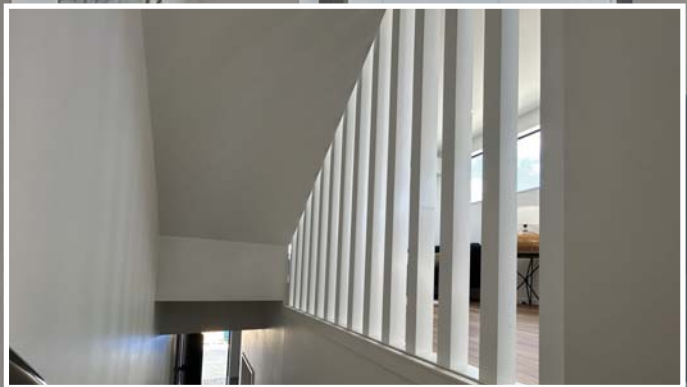

## Slim Rectangular Blade

Full Bull-nose Edge

Cross Section Drawing

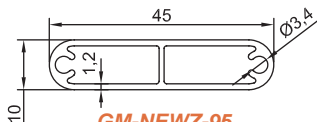

**GM-NEWZ-95**

45x10mm Louvre Blade  
0.41kg/m

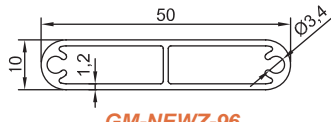

**GM-NEWZ-96**

50x10mm Louvre Blade  
0.42kg/m

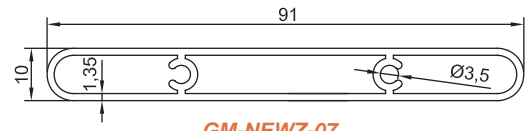

**GM-NEWZ-07**

91x10mm Louvre Blade  
0.88kg/m

## Slim Rectangular Blade

Standard Edge

Cross Section Drawing

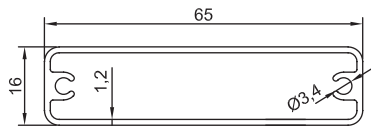

**GM-NEWZ-04**

65x16mm Louvre Blade  
0.65kg/m

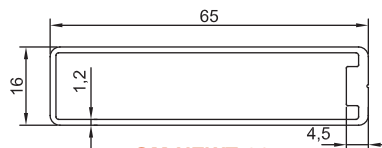

**GM-NEWZ-61**

65x16mm Louvre Blade  
0.69kg/m

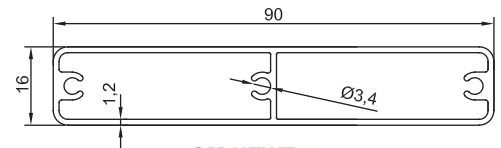

**GM-NEWZ-09**

90x16mm Louvre Blade  
0.86kg/m

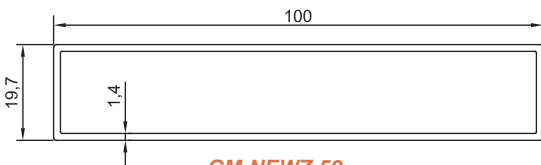

**GM-NEWZ-59**

100x19.7mm Louvre Blade  
0.88kg/m

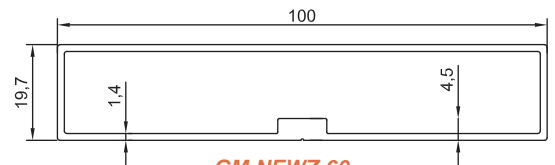

**GM-NEWZ-60**

100x19.7mm Louvre Blade  
0.93kg/m

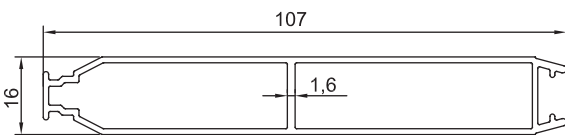

**GM-NEWZ-05**

107x16mm Interlock Louvre Blade  
0.94kg/m

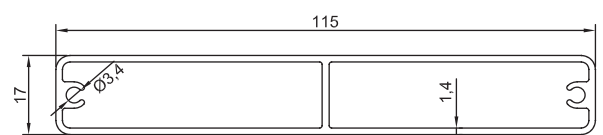

**GM-NEWZ-93**

115x17mm Louvre Blade  
1.16kg/m

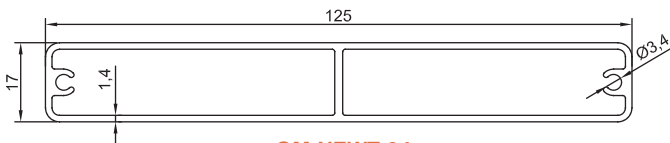

**GM-NEWZ-94**

125x17mm Louvre Blade  
1.25kg/m

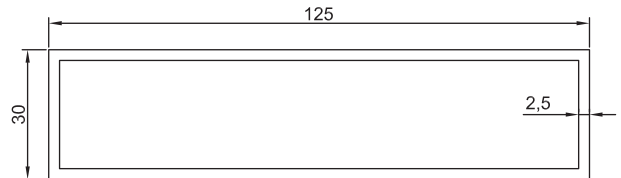

**RHA 125B30T2.5**

125x30mm Louvre Blade  
2.138kg/m

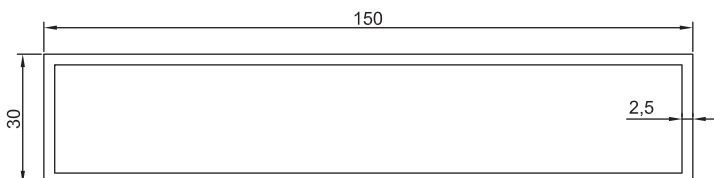

**RHA 150B30T2.5**

150x30mm Louvre Blade  
2.494kg/m

## Fusiform Blade

### Cross Section Drawing

### with End Cap & Holder

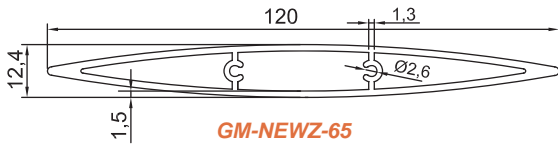

**GM-NEWZ-65**  
120x12.4mm Louvre Blade  
1.17kg/m

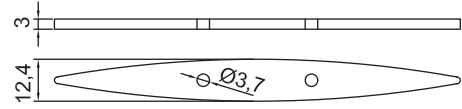

**SL-183**  
GM-NEWZ-65 End Cap

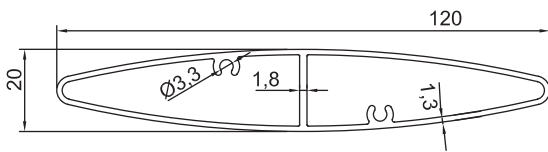

**GM-NEWZ-06**  
120x20mm Louvre Blade  
1.09kg/m

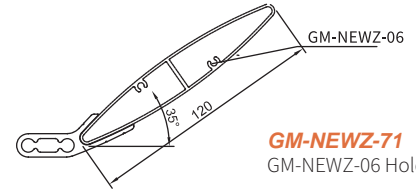
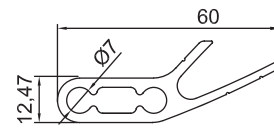

**GM-NEWZ-71**  
GM-NEWZ-06 Holder

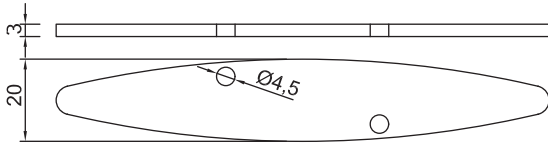

**SL-82**  
GM-NEWZ-06 End Cap

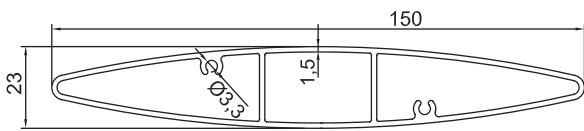

**GM-NEWZ-70**  
150x23mm Louvre Blade  
1.58kg/m

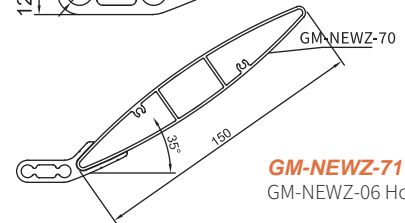
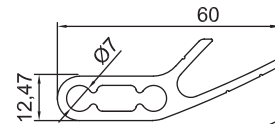

**GM-NEWZ-71**  
GM-NEWZ-06 Holder

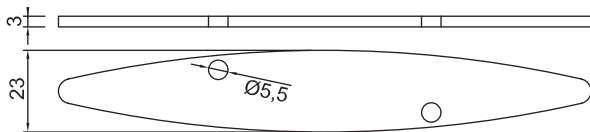

**SL-182**  
GM-NEWZ-70 End Cap

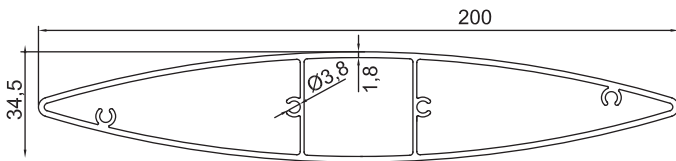

**GM-NEWZ-102**  
200x34.5mm Louvre Blade  
2.45kg/m

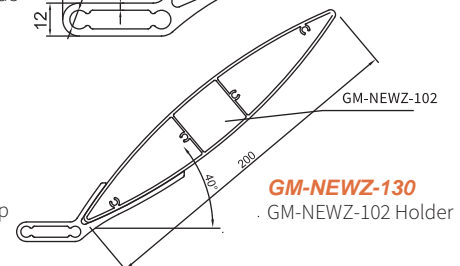
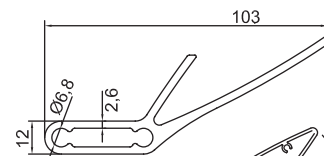

**GM-NEWZ-130**  
GM-NEWZ-102 Holder

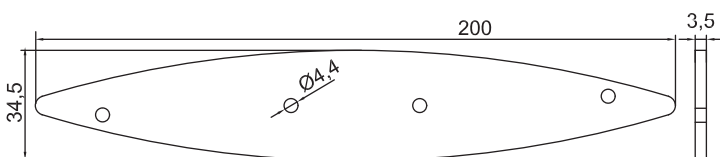

**SL-165**  
GM-NEWZ-102 End Cap

## Quadrilateral Blade with End Cap & Holder

### Cross Section Drawing

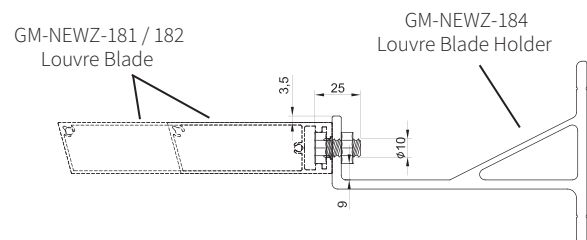
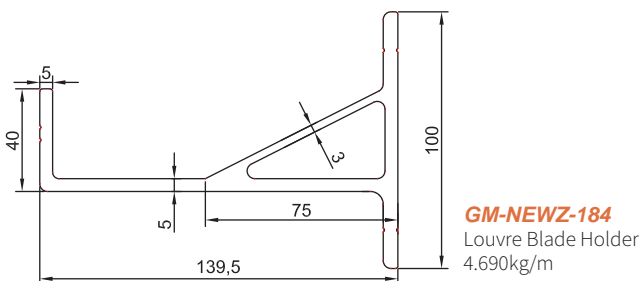
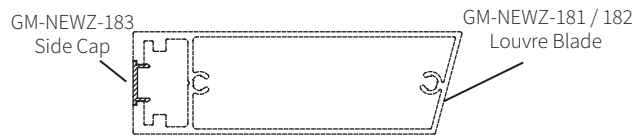
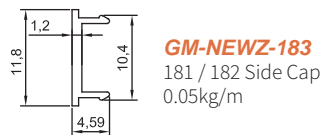
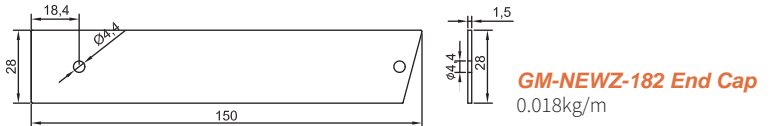
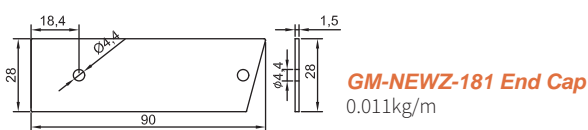
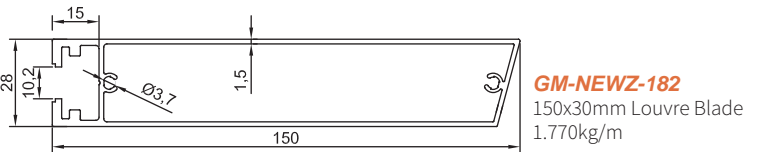
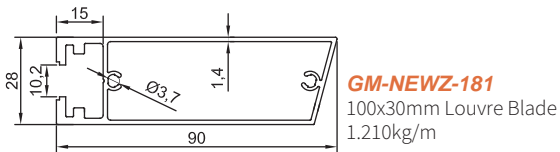
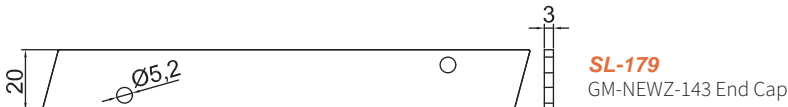
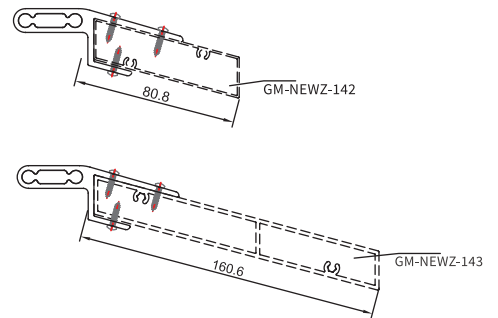
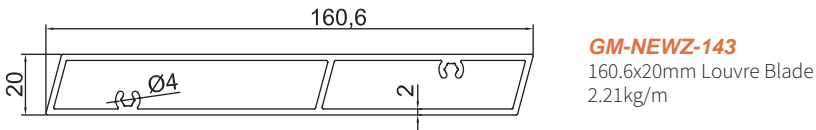
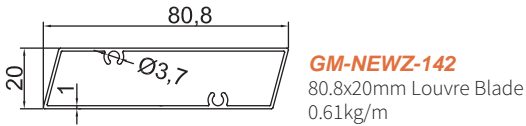

Cross Section Drawing

**Standard Rectangular Blade**  
with End Cap & Holder

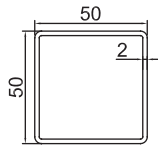

**GM-NEWZ-50x50x2R**  
50x50mm Louvre Blade  
1.13kg/m

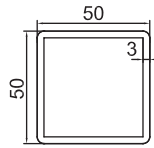

**GM-NEWZ-50x50x3R**  
50x50mm Louvre Blade  
1.67kg/m

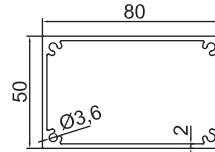

**GM-NEWZ-97**  
80x50mm Louvre Blade  
1.68kg/m

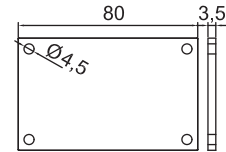

**SL-125**  
GM-NEWZ-97  
End Cap

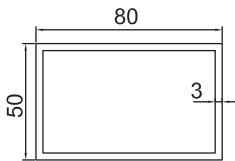

**RHA80B50T3**  
80x50mm Louvre Blade  
2.120kg/m

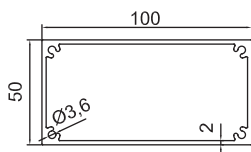

**GM-NEWZ-120**  
100x50mm Louvre Blade  
1.91kg/m

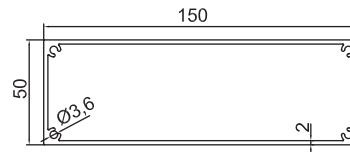

**GM-NEWZ-98**  
150x50mm Louvre Blade  
2.48kg/m

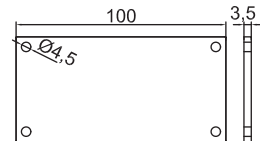

**SL-152**  
GM-NEWZ-120  
End Cap

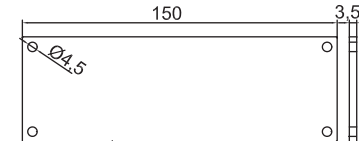

**SL-126**  
GM-NEWZ-98  
End Cap

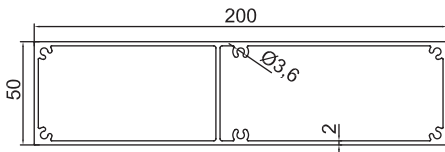

**GM-NEWZ-101**  
200x50mm Louvre Blade  
3.46kg/m

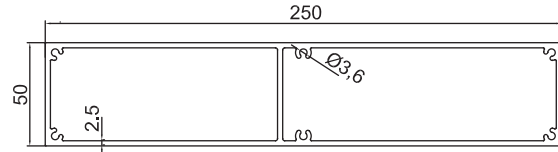

**GM-NEWZ-100**  
250x50mm Louvre Blade  
4.84kg/m

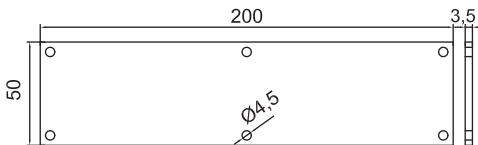

**SL-181**  
GM-NEWZ-101  
End Cap

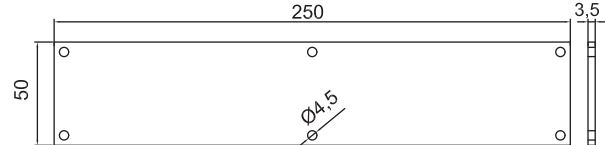

**SL-180**  
GM-NEWZ-100  
End Cap

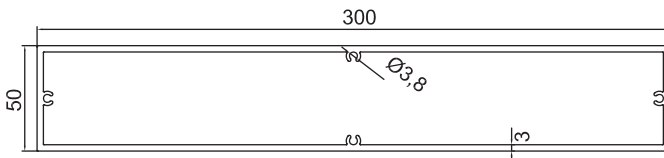

**GM-NEWZ-131**  
300x50mm Louvre Blade  
5.75kg/m

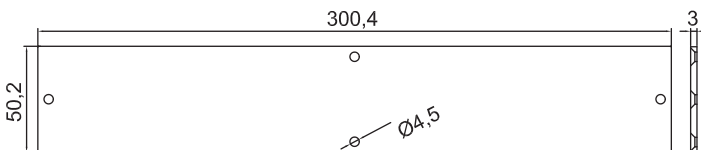

**SL-158**  
GM-NEWZ-131  
End Cap

Cross Section Drawing

## Clip-on Rectangular Blade with End Cap & Holder

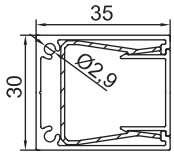

**GM-NEWZ-56&57&58**  
30x35mm Louvre Blade  
0.77kg/m

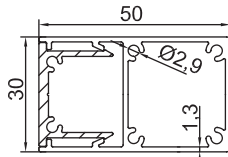

**GM-NEWZ-51&53**  
30x50mm Louvre Blade  
1.07kg/m

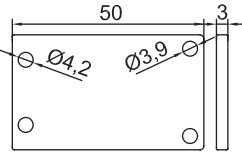

**SL-18**  
GM-NEWZ-51 End Cap

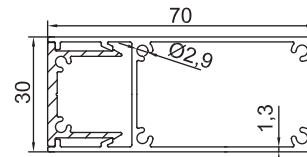

**GM-NEWZ-52&53**  
30x70mm Louvre Blade  
1.22kg/m

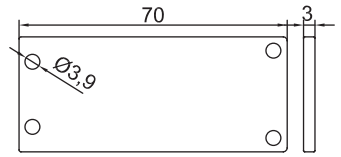

**SL-17**  
GM-NEWZ-52 End Cap

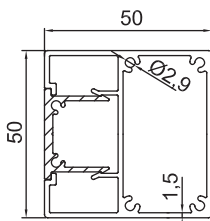

**GM-NEWZ-54&53**  
50x50mm Louvre Blade  
1.48kg/m

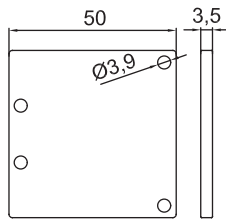

**SL-16**  
GM-NEWZ-54 End Cap

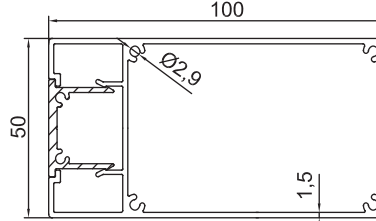

**GM-NEWZ-55&53**  
50x100mm Louvre Blade  
1.91kg/m

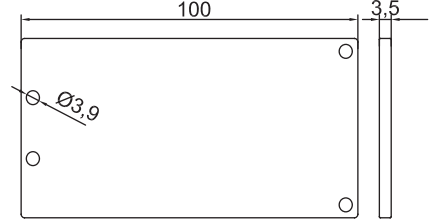

**SL-15**  
GM-NEWZ-55 End Cap

Cross Section Drawing

## Sliding System

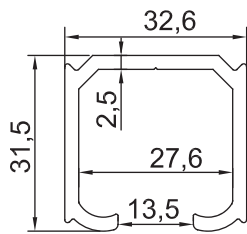

**GM-NEWZ-135**  
Roller Sliding Track  
0.72kg/m

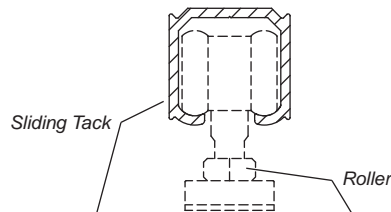

**SL-190**  
Sliding Louvre Roller

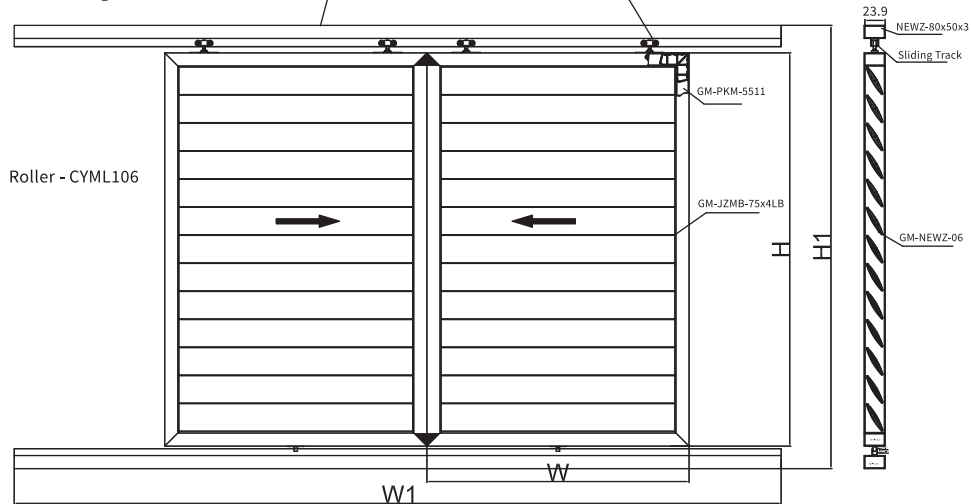

## Flat Window Shroud



## Corner Window Shroud



### Cross Section Drawing

## Window Shroud Profiles

### Window Shroud Holder

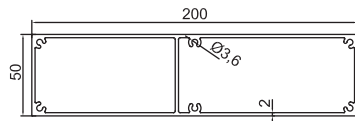
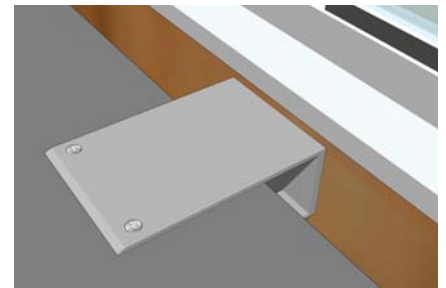

**200mm Window Shroud**  
**GM-NEWZ-101**  
200x50mm Louvre Blade  
3.46kg/m

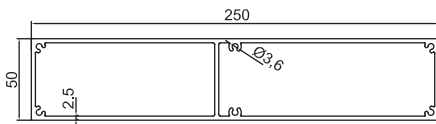

**250mm Window Shroud**  
**GM-NEWZ-100**  
250x50mm Louvre Blade  
4.84kg/m

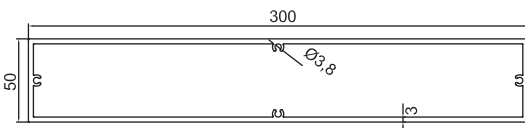

**300mm Window Shroud**  
**GM-NEWZ-131**  
300x50mm Louvre Blade  
5.75kg/m

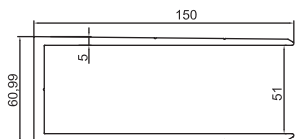

**Window Shroud Holder**  
**GM-NEWZ-145**  
50mm Louvre Blade Holder  
120mm long

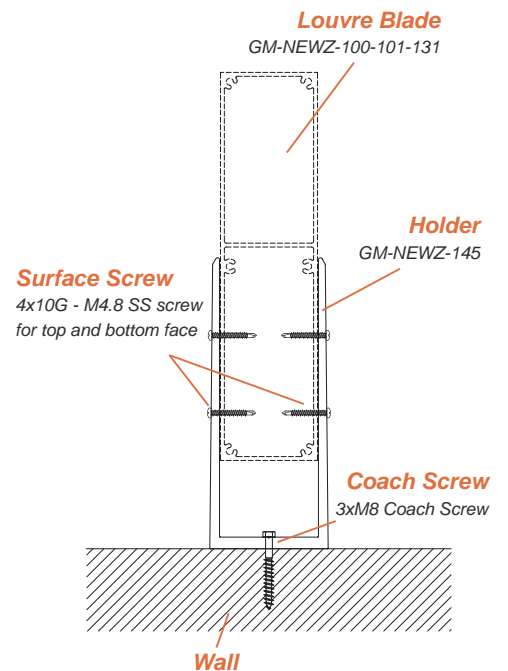

Cross Section Drawing

## Corner Stakes

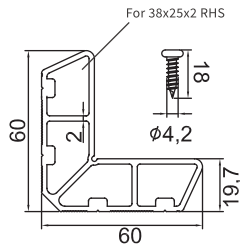

**GM-NEWZ-121**  
38x25mm Corner Stake

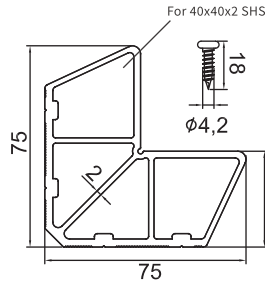

**GM-NEWZ-122**  
40x40mm Corner Stake

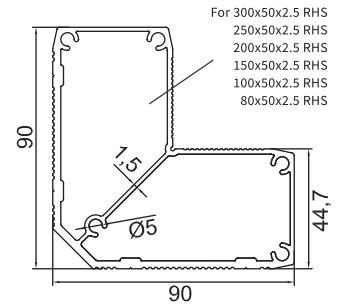

**GM-NEWZ-134**  
50mm Corner Stake

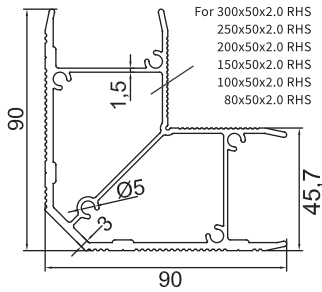

**GM-NEWZ-133**  
50mm Corner Stake

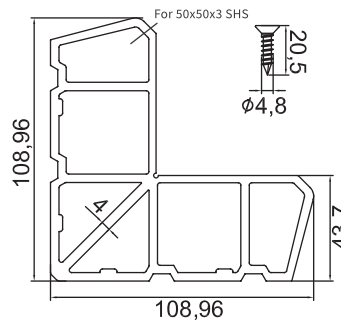

**GM-KPM-5511**  
50x50mm Corner Stake

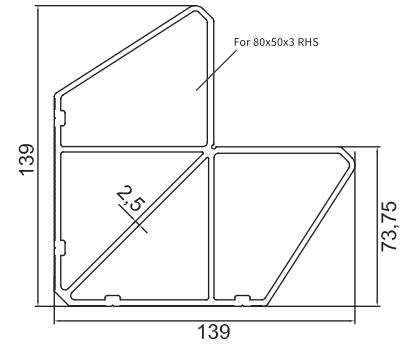

**GM-KPM-123**  
80x50mm Corner Stake

Cross Section Drawing

## Blade Holders

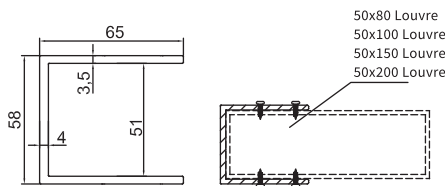

**GM-NEWZ-58x65x3.5U**  
50mm Louvre Blade Holder

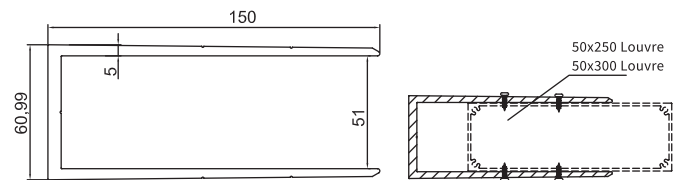

**GM-NEWZ-145**  
50mm Louvre Blade Holder



**GM-NEWZ-157**  
50mm Louvre Blade Holder

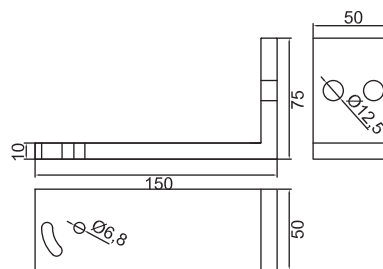

**SL-155**  
GM-NEWZ-157 150mm Stand

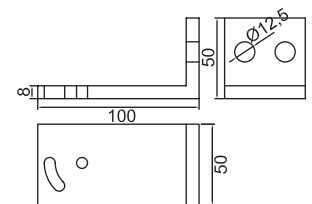

**SL-156**  
GM-NEWZ-157 100mm Stand

## Extrusion Powder Coating

*Our powder coating aluminium provides an attractive, durable, and cost-effective solution that is environmentally friendly and customisable to suit a wide range of design needs.*

**Durability:** Powder coated aluminium is extremely durable and can withstand harsh weather conditions, including extreme heat, cold, and humidity. The powder coating also provides protection against scratches, chipping, and fading, which makes it an ideal choice for outdoor applications.

**Aesthetics:** It provides a smooth, even finish that is available in a wide range of colours and textures. This allows for customisation and flexibility in design choices, making it an attractive option for architectural, automotive, and consumer applications.

**Environmental Sustainability:** Powder coating is an environmentally friendly alternative to liquid paint. It produces very little waste, and the overspray can be collected and reused, reducing waste and saving on material costs. Additionally, powder coating does not emit any volatile organic compounds (VOCs) into the air, making it a safer option for the environment.

### Stocked Colours

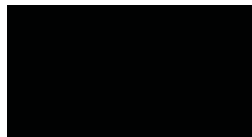

*Matt Black*



*Matt Ironsand*

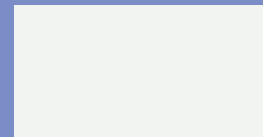

*Matt Appliance White*



*Dark Cedar Wood-grain*

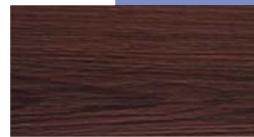

*Antique Wood Wood-grain*

**\* NOTE:** *Custom colours are available upon request, additional costs and lead times may apply.*

# Heat Pump Cover System



- Neat and compact designs to fit directly onto exterior walls.
- Protects units from weather exposure while allowing full airflow.
- Clean architectural finish that complements modern homes.



Designed to fit a wide range of outdoor units from leading brands such as Mitsubishi, Daikin, Gree, Midea, and others — offering both protection and a sleek finish.



## BreezGuard Heat Pump Cover

### FOLD TOP **BreezGuard**

TOP COVER - 3mm Thickness Folded Aluminium Sheet



### WPC TOP **BreezGuard**

TOP COVER - 90mm Width x 20mm Thickness WPC Slats



The BreezGuard cover features horizontal sloping blades that provide a sleek, modern look while effectively concealing the unit from view. Designed to maintain airflow, the angled blades allow for excellent ventilation without compromising appearance—ideal for blending heat pump units into the building facade.

### Blade Profile



**GM-BYP-3470**  
70mm x33.7mm (HxD)  
Zed Blade

## LineShield Heat Pump Cover

### FOLD TOP **LineShield**

TOP COVER - 3mm Thickness Folded Aluminium Sheet

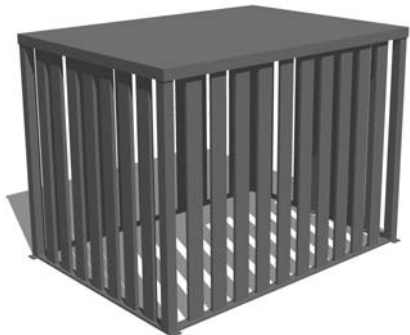

### WPC TOP **LineShield**

TOP COVER - 90mm Width x 20mm Thickness WPC Slats



LineShield is built with vertical RHS bars and evenly spaced gaps to deliver strong protection and consistent ventilation. Its clean, structured look suits both residential and commercial settings offering a durable, low-maintenance solution that performs as well as it looks.

### Blade Profile



**GM-NEWZ-04**  
65mm x16mm (HxD)  
Rectangular Blade

## Installation Options

### SIDE FIX

Features extendable mounting brackets that connect the frame to the wall with 200mm of adjustable spacing. Perfect for areas with uneven surfaces or limited ground space, this method ensures flexibility and a clean, floating appearance.



### TOP FIX

Each post is fitted with a sturdy flange plate for secure top fixing. The frame is bolted down using coach screws, making it ideal for concrete or timber surfaces. This method offers a solid, permanent installation with minimal tools required.

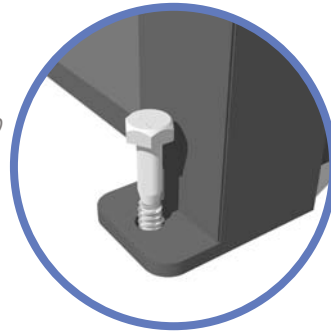

## Stocked Colour Options

The colours shown on the right are for reference only and may vary slightly from the actual product. A wider range of custom colours is also available to suit your specific needs



## Key Features

- Strong, architectural-grade aluminium frame
- Optional WPC top with timber-look finish
- Corrosion-resistant and low maintenance design
- Clean look with mostly hidden fixings
- Secure wall or floor mounting options
- Wide range of powder-coated colour choices
- Custom sizes available to fit any unit
- 10-year residential use warranty included
- Available for delivery across New Zealand

# Entrance Canopy System



- Fixed directly above doors to shield from rain and sun.
- Provides year-round weather protection with a clean, modern look.
- Compact, low-profile design ideal for homes and apartments.



## Flat Panel Entrance Canopy

A minimalist canopy formed from folded aluminium sheet with clean, crisp edges. Fixed securely to the wall with front-mounted support rods, this design offers solid rain protection and a sharp architectural look.

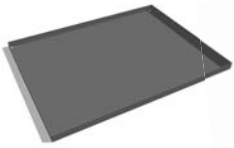

**Folded Aluminium Sheet**

Thickness: 2.0 - 3.0mm  
Grade: 5005 / 5052



**Hanger Rod**

Material: 316L Stainless Steel

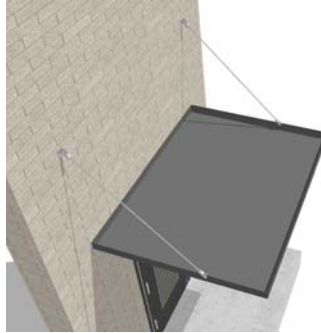

## Louvre Blade Entrance Canopy

A sleek cantilevered canopy featuring angled louvre blades within a framed structure. The open blade design provides ventilation while blocking direct sunlight, with no rods or brackets—just a clean, wall-mounted finish.



**Louvre Blade Profile**

Code: NEWZ-06  
Size: 120mm x20mm



**\* NOTE:** Both Entrance Canopy designs can be fully customised in size and colour to suit your project requirements.







**ALUMINIUM**

## Contact Us Now!

### *Auckland Rosedale Branch*

**Address:** 6 John Glenn Ave, Rosedale,  
Auckland 0632

**Email:** [info.albany@sdalu.co.nz](mailto:info.albany@sdalu.co.nz)

**Phone:** 09 - 218 2188  
09 - 218 2111

### *Auckland Manukau Branch*

**Address:** 28 Ryan Pl, Manukau City,  
Auckland 2104

**Email:** [info.manukau@sdalu.co.nz](mailto:info.manukau@sdalu.co.nz)

**Phone:** 09 - 217 8666

### *Christchurch Wigram Branch*

**Address:** 67 Vickerys Rd, Wigram,  
Christchurch 8042

**Email:** [info.chch@sdalu.co.nz](mailto:info.chch@sdalu.co.nz)

**Phone:** 03 - 366 6669

*Follow Us on Social Media ....*

